

MODEL 500P MagnaValve

999215

- Wheel systems
- Variable flow rates
- No moving parts
- Steel shot
- Steel grit
- $\pm 2\%$ Accuracy
- Built-in flow sensor
- Linear compensator
- 200-1200 lbs/min range
- Normally closed
- Requires FC Flow Controller



The Model 500P MagnaValve is a normally closed magnetic valve suitable for regulation of cast steel shot and includes a built-in sensor for accurate measurement of flow rate. Used with the Model FC Shot Flow Controller, the MagnaValve will provide accurate and repeatable flow rates over a 200 - 1200 pounds-per-minute flow range.

The valve construction includes a permanent magnet for normally closed operation and an electromagnet for controlling shot flow rates. By regulating the voltage to the electromagnet, any desired flow rate may be achieved. When power is off, the valve will hold shot due to the permanent magnet. The pre-amp includes a 9-stage linearity compensator to achieve $\pm 2\%$ accuracy.

For use with stainless steel cut-wire shot contact the factory. The valve will work with some of the larger sizes of stainless steel cut-wire shot.

The 500P will **NOT** work with stainless steel cast shot.

ELECTRONICS INCORPORATED

MODEL 500P MagnaValve

Specifications

Sensor

Power:	±12Vdc from FC Control
Display:	4-digit
Output:	0-5Vdc to FC Control
Adjustments:	Zero, Span, Linearity
Accuracy:	±2% (of Full Scale)

Valve

Power:	+55Vdc @.5A from FC Control
Maximum Flow:	1200 lbs/min (500kg/min)
Range:	200-120lbs/min (100-500kg/min)
Temp:	0-75° C (70-110°F)

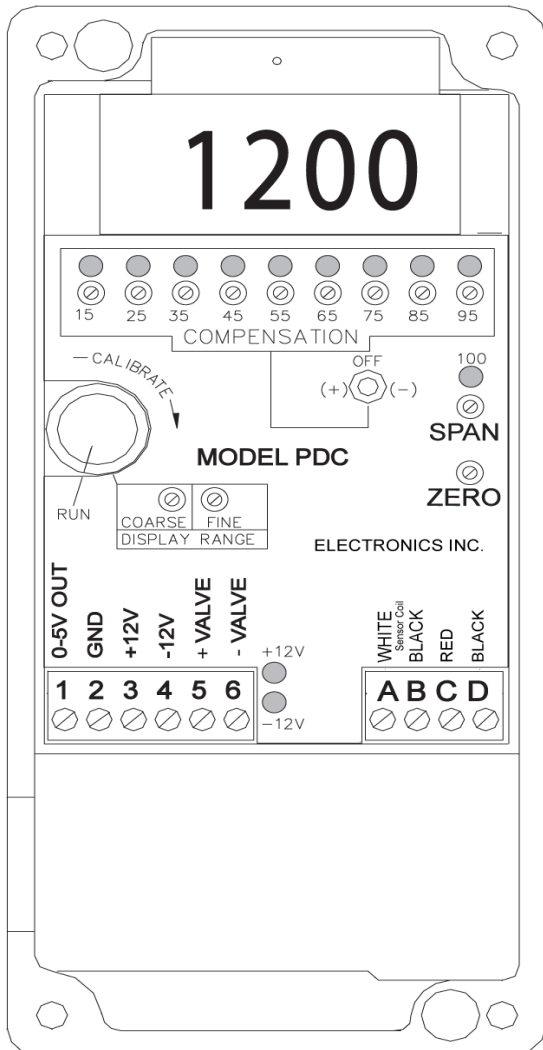
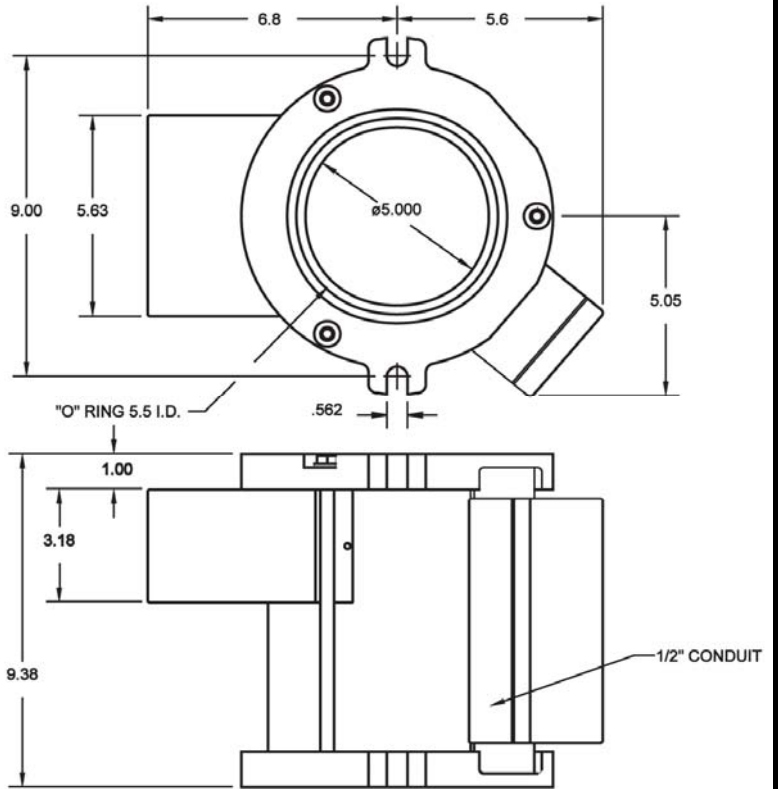

We will calibrate the MagnaValve at the factory prior to shipment. Please specify the type and size of media that you will be using with each valve. If your maximum expected flow rate is less than 1200 lbs/minute or 500 kg/minute you may request a lower range setting. This will improve the valve accuracy at your actual operating conditions.

	MagnaValve Range	FC Control Full Scale Display
Lbs/minute	200-1200	1200
	150-1000	1000
	125-800	800
	90-600	600
Kg/minute	75-500	500
	60-400	400
	50-350	350
	45-300	300

Be sure to specify the FC Control Full Scale Display range when you place your order for the control.